

Purus Sand Trap Channel

Channel with a width of 150mm or 300mm, equipped with a built-in sand trap. Ideal for car washes, workshops or other environments where sand and gravel need to be collected without impairing the flow. The model is offered in three different versions.

Made of acid-resistant stainless steel according to EN 1.4404, and guarantees high quality and long durability.

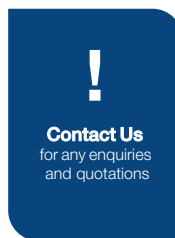

Our products are now on MagiCAD!



[Installation instructions](#)



with sand trap box



with sand trap retaining wall and end outlet

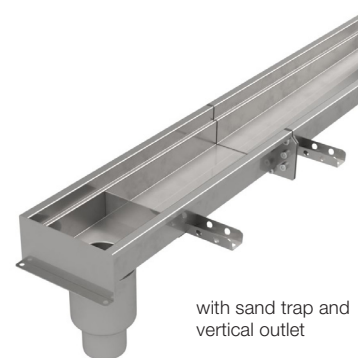

with sand trap and vertical outlet

WITH SAND TRAP BOX

- Width: 150mm or 300mm
- Sand trap for easy emptying
- Outlet 75mm or 110mm, with accessories such as water traps and strainers
- Grate & load class options: L15 Mesh, M125 Mesh or K3 Chess

WITH SAND TRAP RETAINING WALL

- Width: 150mm or 300mm
- Sand retaining wall to stop sand and gravel
- Outlet 75mm or 110mm, with accessories such as water traps and strainers
- Grate & load class options: L15 Mesh, M125 Mesh or K3 Chess

WITH SAND TRAP RETAINING WALL AND END OUTLET

- Width: 150mm or 300mm
- Sand retaining wall to stop sand and gravel
- Lowest installation height
- No outlet gully or water trap
- Grate & load class options: L15 Mesh, M125 Mesh or K3 Chess

FLOOR TYPES

Purus drainage channels in acid-resistant stainless steel are suitable for several different floor types.

For safety and functionality, it is important that the channel type is selected to match the correct floor type.

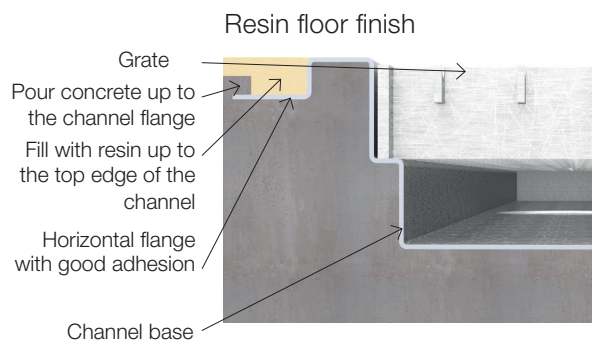
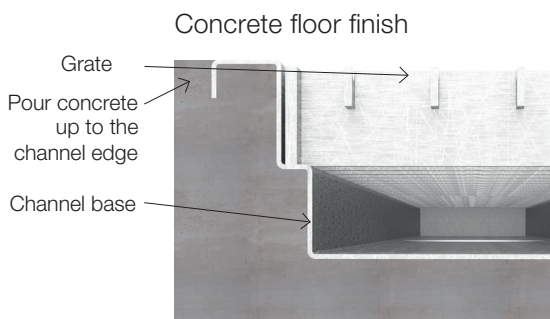

GRATES

Our mesh grates are non-slip and are available in two load classes: L15, which can handle 1500kg, i.e. lighter traffic such as passenger cars; and M125, which corresponds to 12,500kg, i.e. truck traffic and forklift driving.

Strainers in load class K3, which corresponds to 300kg, are primarily used in bathrooms, spas and changing rooms.

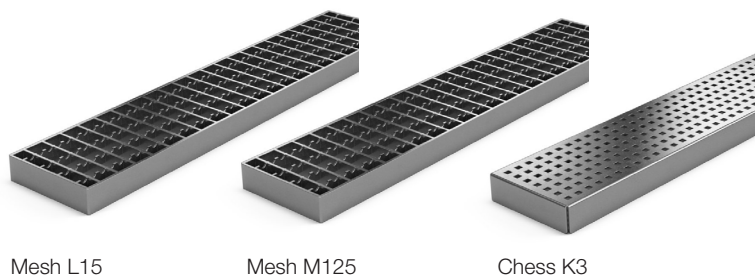

Mesh L15

Mesh M125

Chess K3

Purus offers different water traps depending on the area of application. For higher flow rates without odour problems, an outlet can be used without a trap. Water traps can be retrofitted.

The NOOD water trap, a Purus invention, combines a water trap and a mechanical odour trap, providing double security and protection against backwater, bad odours and pests.

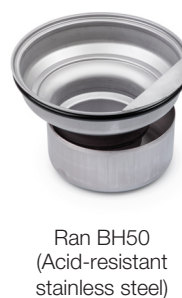

OUTLET GULLIES

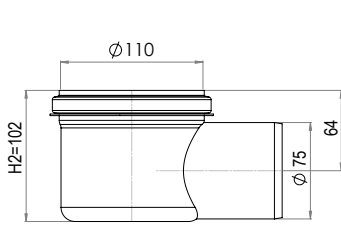

Side 75mm
(Acid-resistant stainless steel)

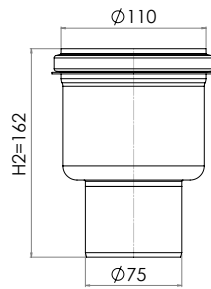

Vertical 75mm
(Acid-resistant stainless steel)

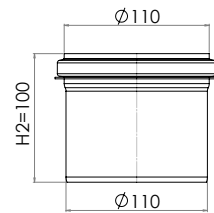

Vertical 110mm
(Acid-resistant stainless steel)

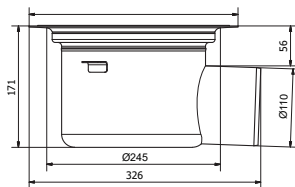

Side 110 mm
(Acid-resistant stainless steel)

ACCESSORIES

Strainers/Filters

These accessories are used to collect particles larger than 5mm, such as leaves, so that they do not fill and block the water trap.

Easily removable for emptying and cleaning.



Strainer

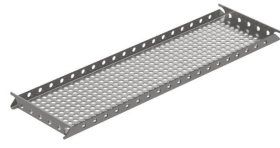

Filter tray



Filter bucket



Sand trap

Installation supports

The Purus Support and M8 mounting feet are tools that fix and support the channel when embedded in concrete floors. Both supports have a light and stable construction.



Purus Support

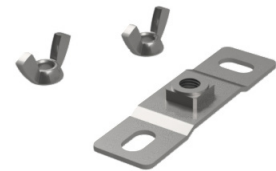

M8 Mounting Foot

Anchor brackets

The channels are fitted with anchor brackets for simple attachment to the floor. Before pouring concrete, use one of Purus's installation supports or nail wire.

